

sunbreaker system

Colours



The products we offer can be any colour from the RAL palette.

For powder coating Selt company uses paints provided by a renowned Swiss company - IGP. Using the IGP-DURA®Clean powders produces a coating which is resistant to dirt and easy to maintain.

Rotating mechanism

The rotating mechanism is placed in the guide rail on the drive side and comprises two movable aluminium strips and a set of blade carriers, an adapter and blade bearings – one set for each blade. The rotating mechanism is connected to the motor and allows for 0-90 degree rotation.

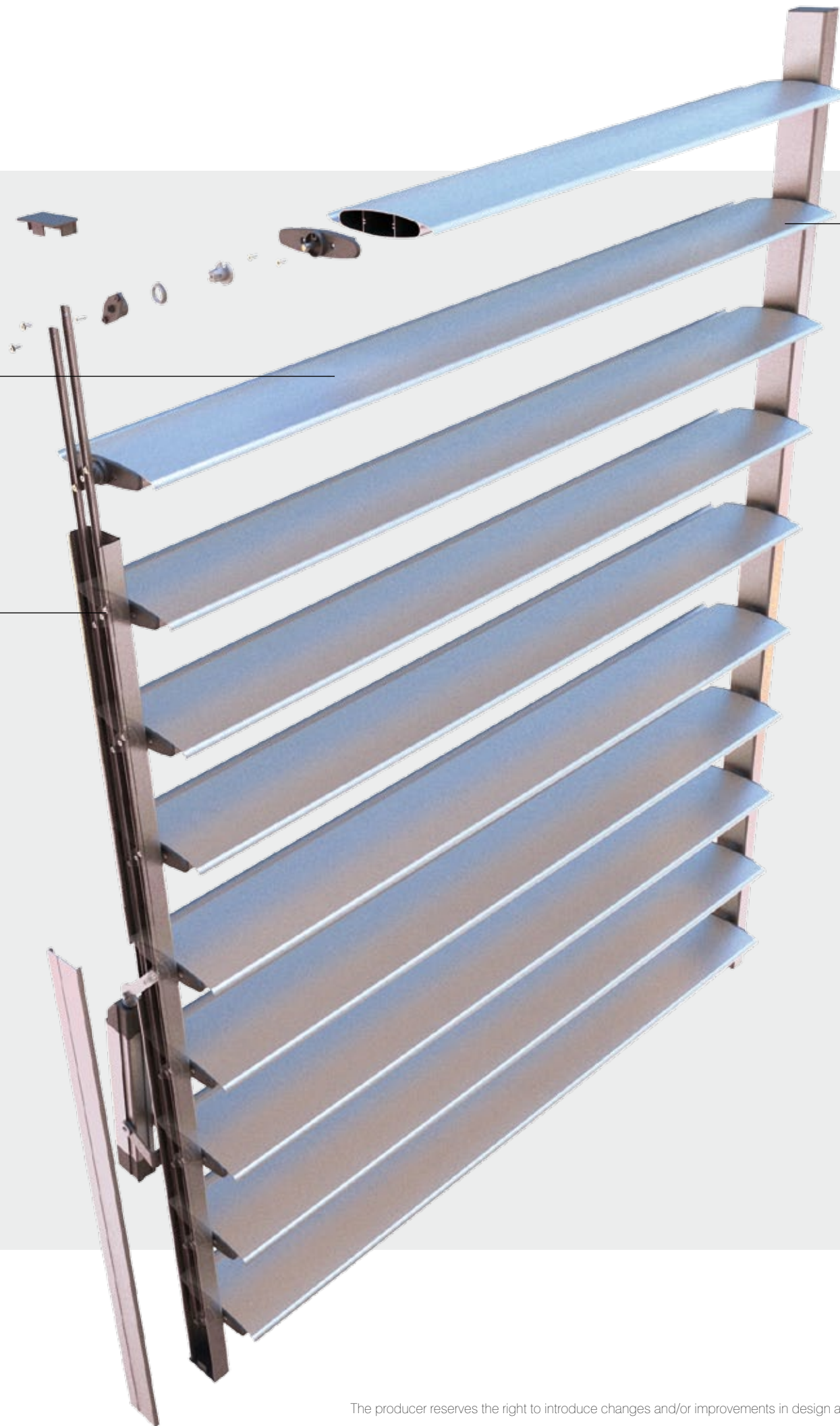
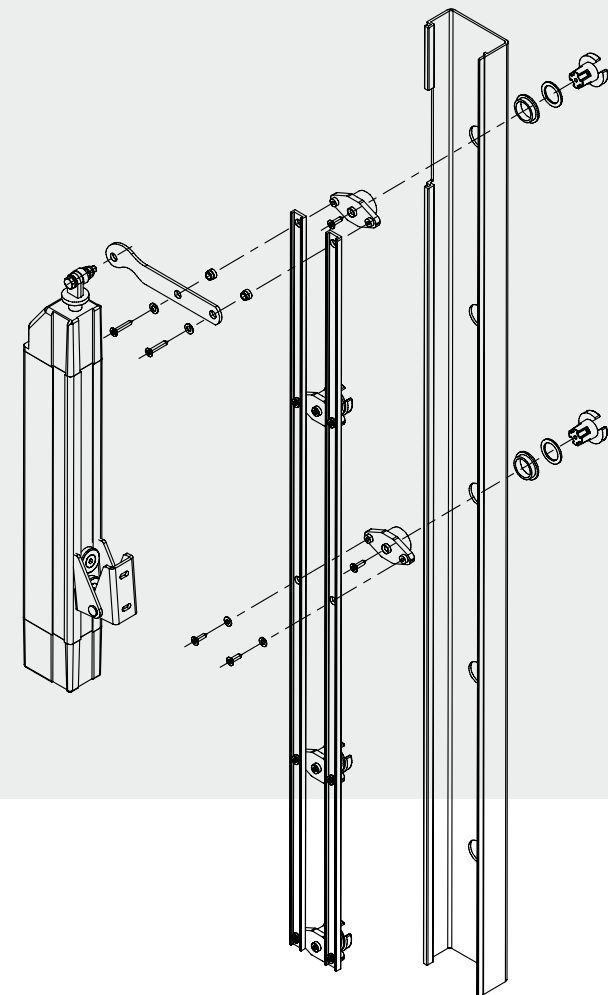

Construction

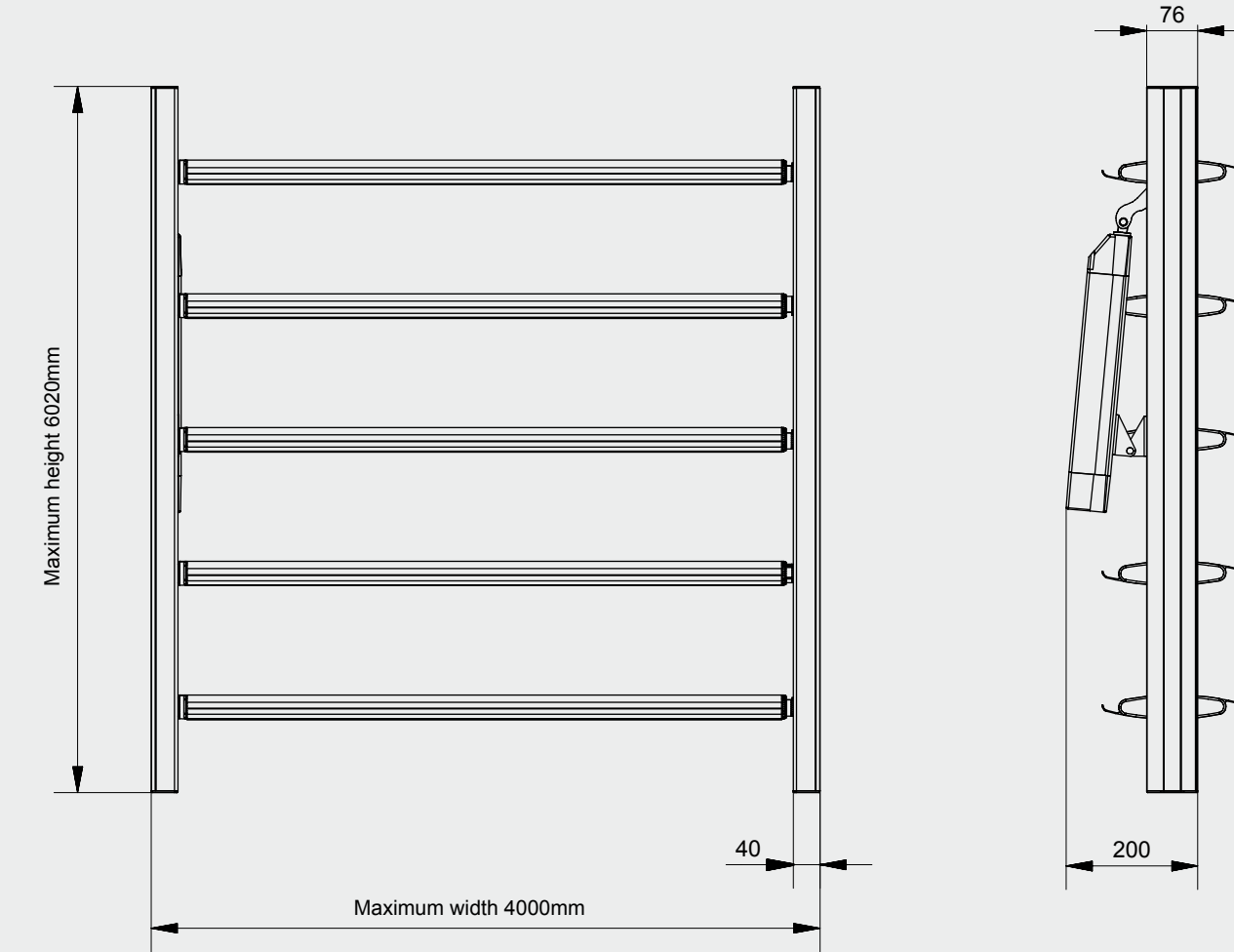

The blades and guide rails in the Sunbreaker system are made from extruded aluminium.

Construction of the blades: the wall thickness and the use of internal braces guarantee the entire construction to be lightweight, yet highly durable. The blades are fixed to the guides with elements made of fibreglass-reinforced strong plastic. The blade bearings in the guides as well as the construction of the drive elements ensure noiseless operation of the system, both when the blades are in motion and when they are in the fixed position. A specially designed system for fixing the blades enables quick assembly and disassembly without having to use any special tools.

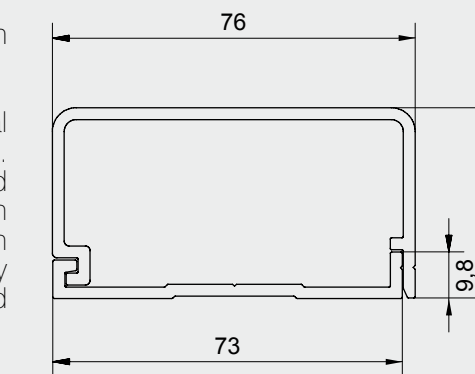

Type A blades are designed for horizontal surfaces (roofing, skylights). Owing to the special shape of the blade when in the closed position, it provides protection from rain.

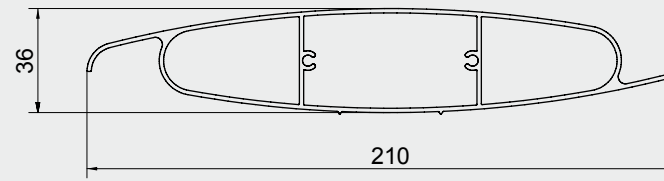

Type B blades are designed for shielding horizontal and vertical surfaces (building façades, pergola walls). Owing to its shape, the blades provide aesthetic protection from the sun.

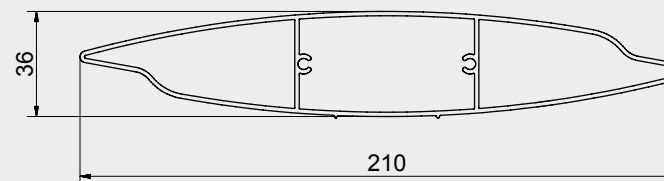

Type B blades are also available as a fixed, non-rotating system. The blades are fixed with special brackets made of extruded aluminium, which allow for the positioning of a blade at an angle of 0-15-30-45-60°. With the brackets, it is possible to fix the blades directly to the building wall or façade. It is also possible to fix the blades through side installation brackets. Depending on your needs, we can offer several types of side brackets.

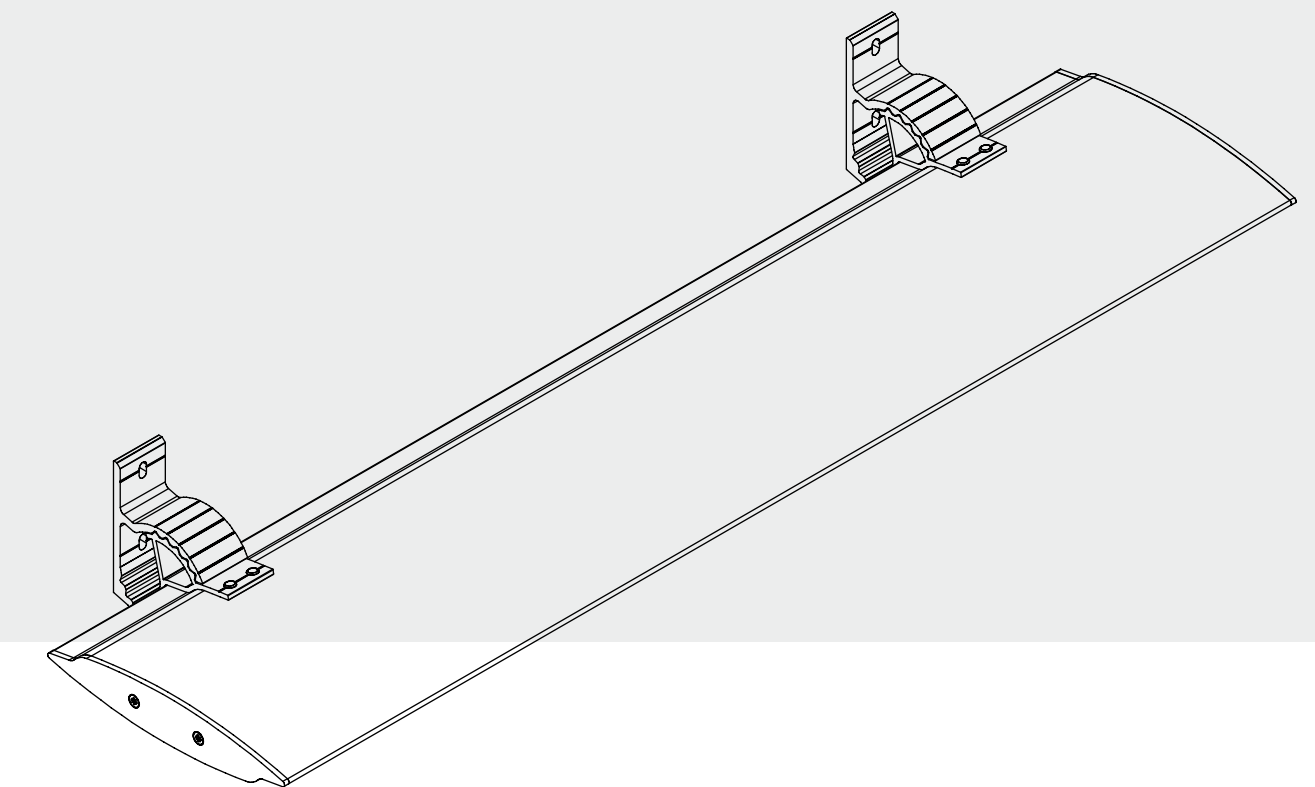
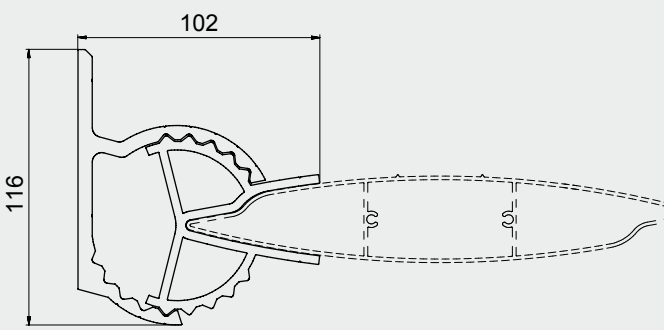

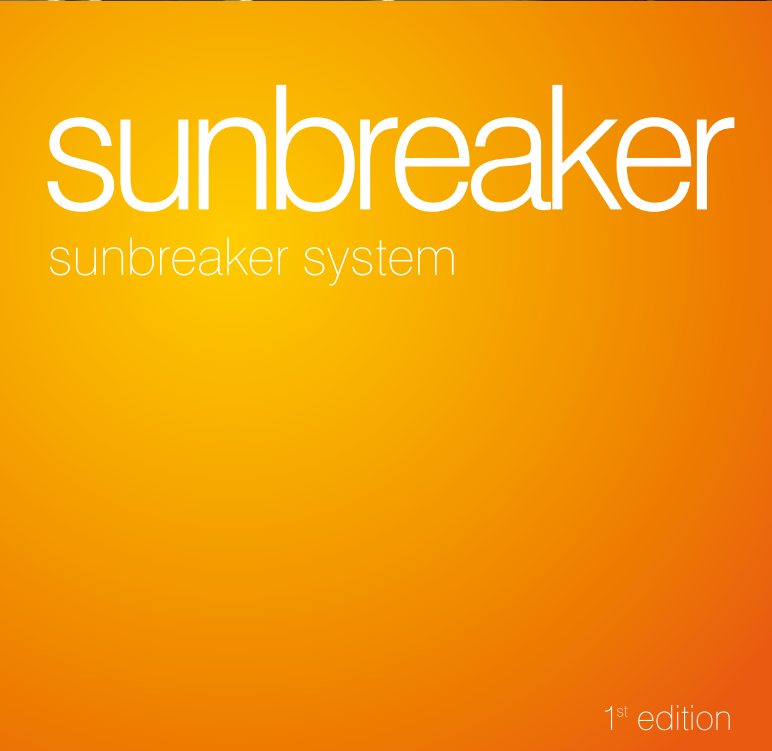

sunbreaker system

- maximum dimensions of a single unit:
4m wide and 6.02m high,
- aluminium construction available in any colour from the RAL palette,
- tilt angle fixed or motor-adjusted,
- lightweight aluminium construction for strength and durability,
- modern and aesthetic.

The **Sunbreaker** system is a highly efficient external shading system, which can also serve as a decorative part of the building. The blades and guide rails are made of thin-walled extruded aluminium, which makes the whole construction lightweight, yet durable. Sunbreaker is a mobile system with a blade rotation range from **0 to 90 degrees**; it can be fixed both horizontally and vertically.

Sunbreaker is a perfect way of making a building more architecturally attractive and for reducing energy consumption from air conditioning.



www.selt.pl



Maximum dimensions of the **Sunbreaker** system: width – 4000mm; height - 6020mm. This system is available for modular assembly.